

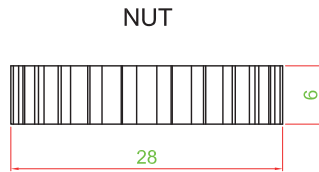

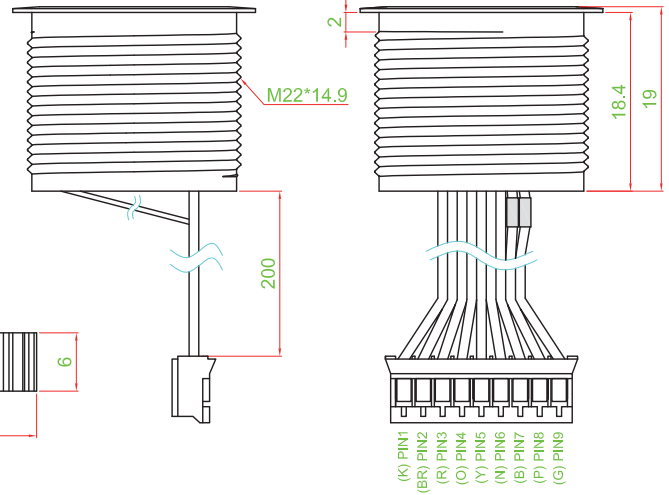

► DIMENSION

TS004-DM11HANKKK3□□□□-W200C

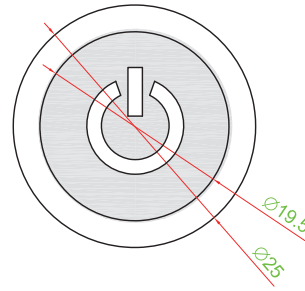

(K) PIN1  
(BR) PIN2  
(R) PIN3  
(O) PIN4  
(Y) PIN5  
(N) PIN6  
(B) PIN7  
(P) PIN8  
(G) PIN9

► CIRCUIT

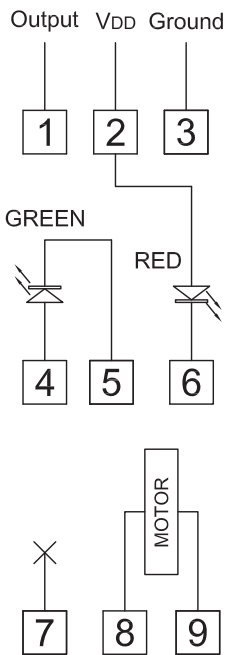

SINGLE COLOR

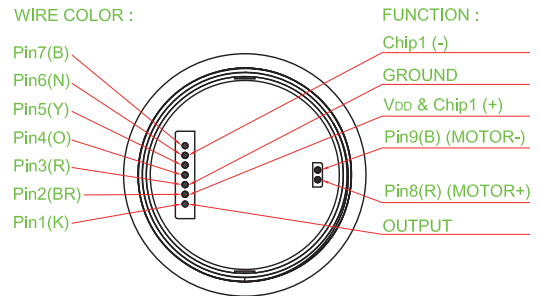

TWO COLOR

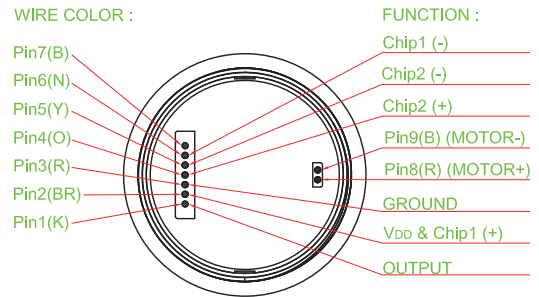

FULL COLOR

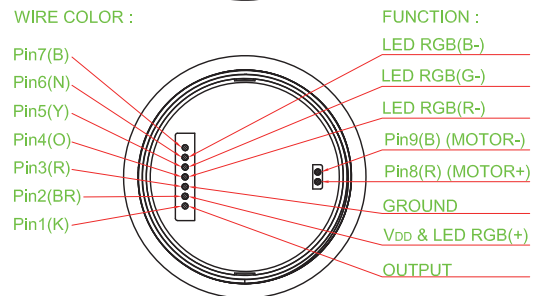

- TACT SWITCH
- PUSH BUTTON SWITCH
- LED TOUCH SENSOR SWITCH
- 5 DIRECTION NAVIGATION SWITCH WITH LED
- MEMBRANE SWITCH
- LED LIGHT BAR
- SLIDE SWITCH
- ROTARY SWITCH
- ROCKER SWITCH
- DETECT SWITCH
- ENCODER
- INTERRUPTER
- MINIATURE MICRO SWITCH
- TELEPHONE HOOK SWITCH
- DOOR SWITCH
- MINI SIZE SOCKET
- KNOB
- CAP SYMBOL